

Art.- Nr. KU 8006



Klöber Benelux PGmbH
Herbesthaler Str. 36
B-4700 Eupen
Tel. +32 (0)87/56 10 56
Fax +32 (0)87/56 12 56
www.kloeber.be
info@kloeber.be

HPI - CZ spol. s r.o.,
Kotrčova 306
503 01 Hradec Králové
Czech Republic
Tel. +420 (0)495 800 912
Fax +420 (0)495 217 290
www.hpi-cz.cz
info@hpi-cz.cz

BMI Deutschland GmbH
Frankfurter Landstraße 2-4
61440 Oberursel
Germany
www.kloeber.de
Kundenservice
Tel. +49 (0)6104 8010 1700
info.kloeber@bmigroup.com
Technische Beratung
Tel. +49 (0)6104 8010 3400
awt.beratung.de@bmigroup.com

Klober Ltd
Unit 6F
East Midlands Distribution Centre
Short Lane
Castle Donington
Derbyshire, DE74 2HA
UK
Tel: +44 (0)1332 813 050
Fax: +44 (0)1332 814 033
www.klober.co.uk
info@klober.co.uk

Technische Änderungen vorbehalten. 12/2024
We reserve the right to make technical changes. 12/2024
Nous nous réservons le droit de faire des modifications techniques.
We behouden ons het recht om technische wijzigingen te maken. 12/2024

KLOBER



Universeller Dichtring für Rohrdurchführungen DN 110, 125, 160, 180

Verlegeanleitung

Universal Sealing Ring for pipe lead through \varnothing 110, 125, 160, 180 - Installation instructions
Joint Universel pour Raccordement de Tuyaux \varnothing 110, 125, 160, 180 - Instructions de pose
Universele dichtingsring voor loden buizen \varnothing 110, 125, 160, 180 - Verwerkingsrichtlijnen

Art.- Nr. KU 8006



KLOBER

Universeller Dichtring für Rohrdurchführungen DN 110, 125, 160, 180 / Universal sealing ring for pipe penetrations Ø 110, 125, 160, 180

Joint Universel pour Raccordement de Tuyaux Ø 110, 125, 160, 180 / Universele dichtingsring voor loden buizen Ø 110, 125, 160, 180

TEILE /
COMPONENTS /
ACCESSOIRES NÉCESSAIRES /
BENODIGDHEDEN

WERKZEUG /
TOOLS /
OUTILS NÉCESSAIRES /
WERKTUIGEN

OHNE WÄRMEDÄMMEINSATZ /
WITHOUT INSULATION /
SANS ISOLANT /
ZONDER ISOLATIE

MIT WÄRMEDÄMMEINSATZ /
WITH INSULATION /
AVEC ISOLANT /
MET ISOLATIE

REGENSICHERE LOTRECHTE DURCHFÜHRUNG
RAINTIGHT PERPENDICULAR PENETRATION
VERTICALE TUYAUX DE RACCORDEMENT ÉTANCHE À LA PLUIE
REGENDICHT VERTICALE VENTILATIEBUIZEN

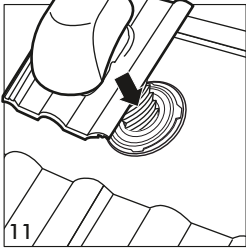
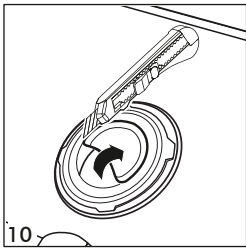
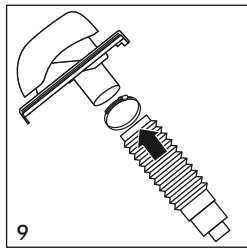
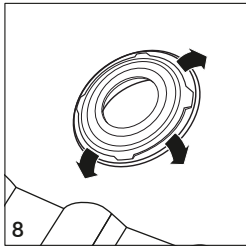
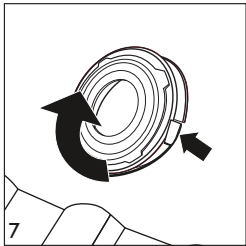
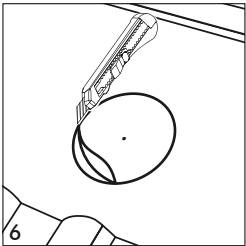
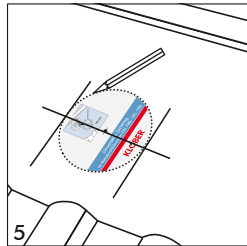
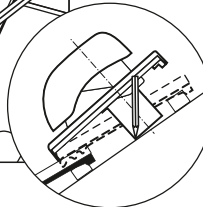
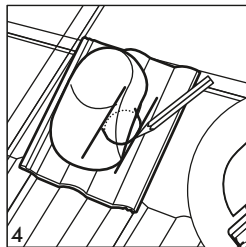
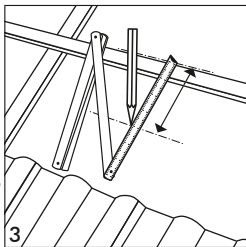
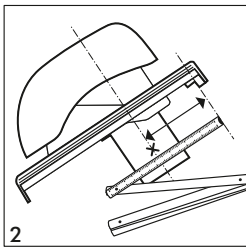
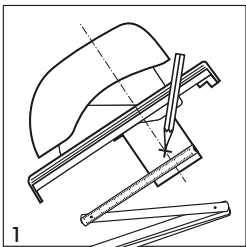
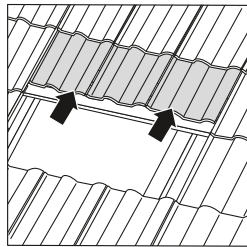
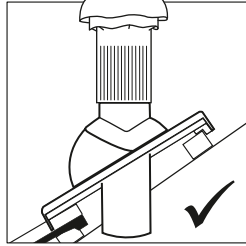
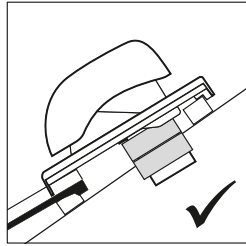
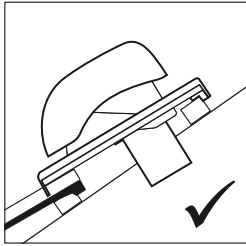
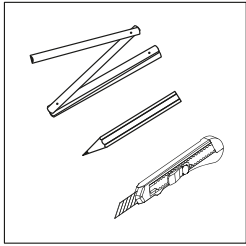
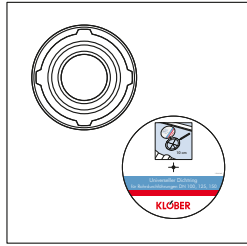

DN 110 / Ø 110 mm
DN 125 / Ø 125 mm
DN 110 / Ø 110 / mit Wärmedämmeinsatz /
with insulation / avec isolant/ met isolatie
DN 160 / Ø 160 mm
DN 180 / Ø 180 mm
DN 160 / Ø 160 / mit Wärmedämmeinsatz /
with insulation / avec isolant/ met isolatie

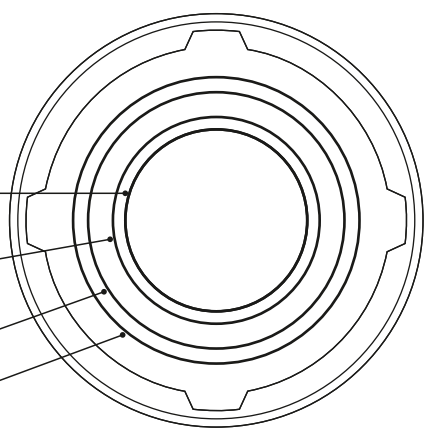

6A =8Yi tgjW'UbX; a V<
: flub_7 flYf @jbXgflUEY &l (
*%(\$ C VYfi fgr
Germany
k k k "_cYVYf"XY
?i bXYbgfj JW
HY" Z (- 'fSt" %S(; %S\$ %+\$S
]bZ" _cYVYf4 Va][fci d"Véa
HVVWbjgWY 6YfUhi b[
HY" Z (- 'fSt" %S(; %S\$ " (\$S
UK HVYfUhi b["XY4 Va][fci d"Véa